

CONFIDENTIAL

CORNER COMMERCIAL BUILDING FOR SALE ON ONE OF BEST BLOCKS OF IRVING! 701 IRVING STREET, SAN FRANCISCO, CA 94122 | INNER SUNSET



JEREMY BLATTEIS
415.321.7493
jfblatteis@blatteisrealty.com
DRE #01460566

JONATHAN BLATTEIS
415.321.7486
jblatteis@blatteisrealty.com
DRE #00812015

ANDREW KRAFT
415.233.2142
akraft@blatteisrealty.com
DRE #02019054

SHARON KIM
415.310.2565
skim@blatteisrealty.com
DRE #01865334

PROPERTY SUMMARY

Blatteis Realty Co. is proud to present 701 Irving Street, a terrific commercial building that brings together location, foot traffic, and visibility for a truly exceptional investment. Situated at the southwest corner of Irving Street and 8th Avenue, this property offers the perfect blend of convenience and visibility with a beautiful facade.

Located in the Inner Sunset District, one of San Francisco's most popular neighborhoods offering local shops, restaurants and cafes that bring plenty of foot and vehicle traffic.

Currently leased to Citibank, this property is an ideal opportunity for an investor, or developer to purchase a property in one of San Francisco's well located and sought-after neighborhoods.

Please Do Not Disturb Tenant.

PROPERTY DETAILS:

Please Call for Price

Property Type:	Commercial
Building Size:	±5,390 Sq Ft (Per Realquest)
Lot Size:	±2,625 Sq Ft (Per Realquest)
Cross Street:	8th Avenue
Year Built:	1922
APN:	1763-001



CELEBRATING
100 Years

JEREMY BLATTEIS

415.321.7493
jfblatteis@blatteisrealty.com
DRE #01460566

JONATHAN BLATTEIS

415.321.7486
jblatteis@blatteisrealty.com
DRE #00812015

ANDREW KRAFT

415.233.2142
akraft@blatteisrealty.com
DRE #02019054

SHARON KIM

415.310.2565
skim@blatteisrealty.com
DRE #01865334

sfretail.net

This Statement with the information it contains is given with the understanding that all negotiations relating to the purchase, renting or leasing of the property described above shall be conducted through Blatteis Realty Company. The above information, while not guaranteed, has been secured from sources believed to be reliable. Blatteis Realty has not verified its accuracy and make no guarantees, warranty or representation regarding this information and it is published subject to the possibility of errors, omissions, changes of listing information including price, term, financing, or withdrawal without notice. We include projections, estimates, opinions and/or assumptions, for example only, and they may not represent current or future performance of the property. You should consult your tax and legal advisors before to verify the validity of estimates. All commercial or mixed-use property presented by Blatteis Realty is subject to local zoning codes and regulations. It is the sole responsibility and liability of tenants and property owners to obtain all applicable required building permits and/or certificates from the local city/town Planning Department before commercial property use can commence or a building can be built.

101 Montgomery Suite 888, San Francisco, CA 94104 | t: 415.981.2844 | f: 415.981.4986 | info@brsf.co | DRE #01421282



Lincon Way

- Little Shamrock
- Park Gyros
- Green Apple Books
- Jenny's Burger
- Gordo Taqueria
- Marnee Thai
- Sunset Gym
- Little Sweet

10th Ave

- Kiki Japanese
- Ebisu
- Qing Shu
- Patxi's Pizza
- 828 Irving
- Market
- Blackhorn
- Perilla
- One Medical

Irving St

- Beanery
- Mucky Duck
- Nabe
- Arizmendi
- AT&T Store
- Sushi Kazu
- Manna

9th Ave

- Pacific Catch
- MIXT
- Um.ma
- Underdog Tres
- Tartine
- Misdirections
- Fiorella
- Sunset Subs
- San Franpsycho
- Luke's Local
- Pasquale's Pizzeria
- La Fonda
- Poke Origin
- Easy Breezy
- Yancy's Saloon
- Posh Bagel
- Saint Frank
- Ambiance

8th Ave

- The Beanery
- Radiance Jewelry
- Chloe's Closet
- Crepevine
- Crossroads Trading
- Midnite Bagel
- Amazing Fantasy
- Cafe Rain Tree

7th Ave

- Loving Hut
- Foghorn Taproom

Hugo Ave

6th Ave

- Lime Tree

11th Ave

- Artistic Nail Care
- Channel 910
- Yahaira's Hair
- Sakura

- New Eritrea
- Eddy's Liquor & Deli

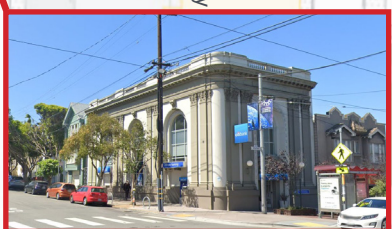

701 IRVING ST

NEARBY TENANTS AND ATTRACTIONS!



PACIFIC CATCH



LUKE'S LOCAL



PASQUALE'S PIZZERIA



EASY BREEZY FROZEN YOGURT



GOLDEN GATE PARK



POSH BAGEL



MIXT SALAD



LALE



CAFE RAIN TREE



CELEBRATING
100 Years

JEREMY BLATTEIS

415.321.7493

jfblatteis@blatteisrealty.com

DRE #01460566

JONATHAN BLATTEIS

415.321.7486

jblatteis@blatteisrealty.com

DRE #00812015

ANDREW KRAFT

415.233.2142

akraft@blatteisrealty.com

DRE #02019054

SHARON KIM

415.310.2565

skim@blatteisrealty.com

DRE #01865334

sfretail.net

This Statement with the information it contains is given with the understanding that all negotiations relating to the purchase, renting or leasing of the property described above shall be conducted through Blatteis Realty Company. The above information, while not guaranteed, has been secured from sources believed to be reliable. Blatteis Realty has not verified its accuracy and make no guarantees, warranty or representation regarding this information and it is published subject to the possibility of errors, omissions, changes of listing information including price, term, financing, or withdrawal without notice. We include projections, estimates, opinions and/or assumptions, for example only, and they may not represent current or future performance of the property. You should consult your tax and legal advisors before to verify the validity of estimates. All commercial or mixed-use property presented by Blatteis Realty is subject to local zoning codes and regulations. It is the sole responsibility and liability of tenants and property owners to obtain all applicable required building permits and/or certificates from the local city/town Planning Department before commercial property use can commence or a building can be built.

101 Montgomery Suite 888, San Francisco, CA 94104 | t: 415.981.2844 | f: 415.981.4986 | info@brsfco | DRE #01421282

701

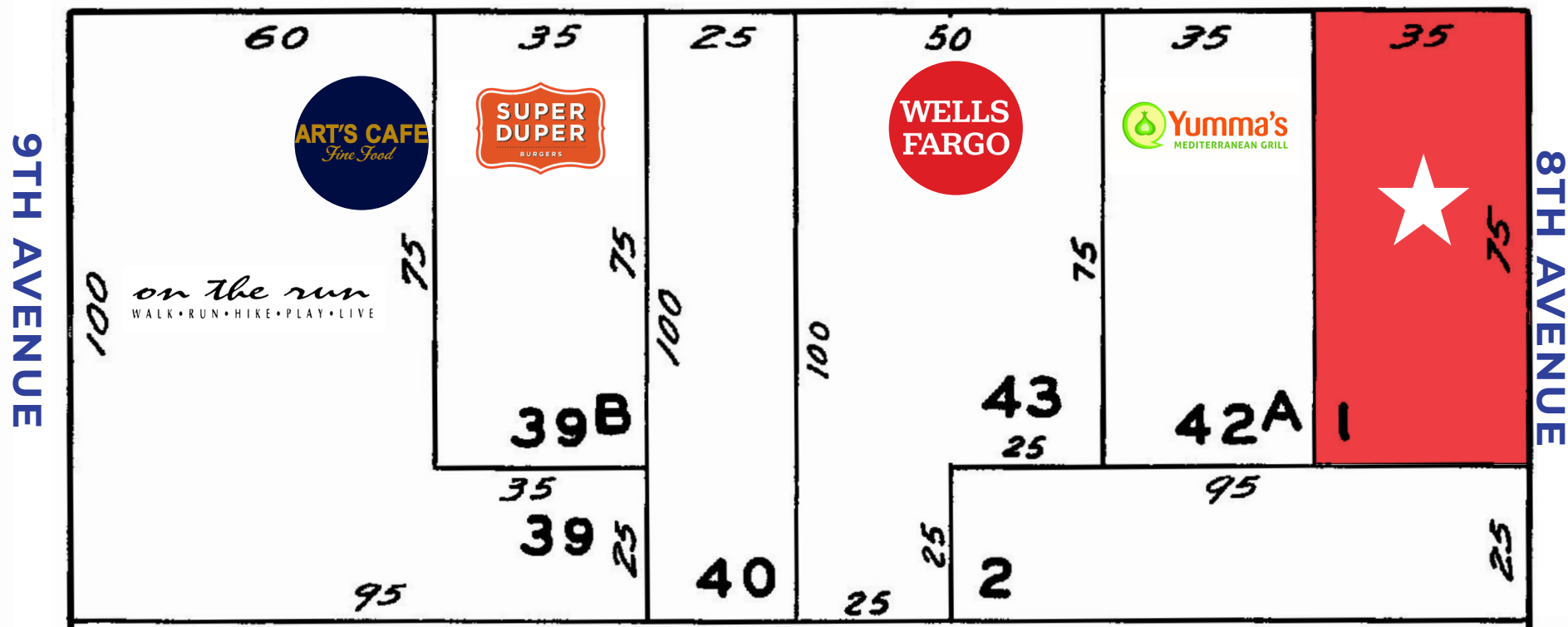

m@blatteisrealty.com
DRE #01865334

sfretail.net

This Statement with the information it contains is given with the understanding that all negotiations relating to the purchase, renting or leasing of the property described above shall be conducted through Blatteis Realty Company. The above information, while not guaranteed, has been secured from sources believed to be reliable. Blatteis Realty has not verified its accuracy and make no guarantees, warranty or representation regarding this information and it is published subject to the possibility of errors, omissions, changes of listing information including price, term, financing, or withdrawal without notice. We include projections, estimates, opinions and/or assumptions, for example only, and they may not represent current or future performance of the property. You should consult your tax and legal advisors before to verify the validity of estimates. All commercial or mixed-use property presented by Blatteis Realty is subject to local zoning codes and regulations. It is the sole responsibility and liability of tenants and property owners to obtain all applicable required building permits and/or certificates from the local city/town Planning Department before commercial property use can commence or a building can be built.

101 Montgomery Suite 888, San Francisco, CA 94104 | t: 415.981.2844 | f: 415.981.4986 | info@brsf.co | DRE #01421282

DEMOGRAPHICS

	1 MILE	3 MILES	5 MILES
2024 Total Population	48,818	436,680	824,159
2029 Population	45,301	404,016	762,687
Pop Growth 2024-2029	7.20%	7.48%	7.46%
Average Age	41	43	42
2024 Total Households	20,365	188,711	346,314
HH Growth 2024-2029	7.76%	7.92%	7.80%
Median Household Inc	\$146,841	\$141,438	\$125,203
Avg Household Size	2.30	2.20	2.20
2024 Avg HH Vehicles	1.00	1.00	1.00
Median Home Value	\$1,124,969	\$1,115,224	\$1,096,556
Median Year Built	1947	1948	1949

Source: Loopnet

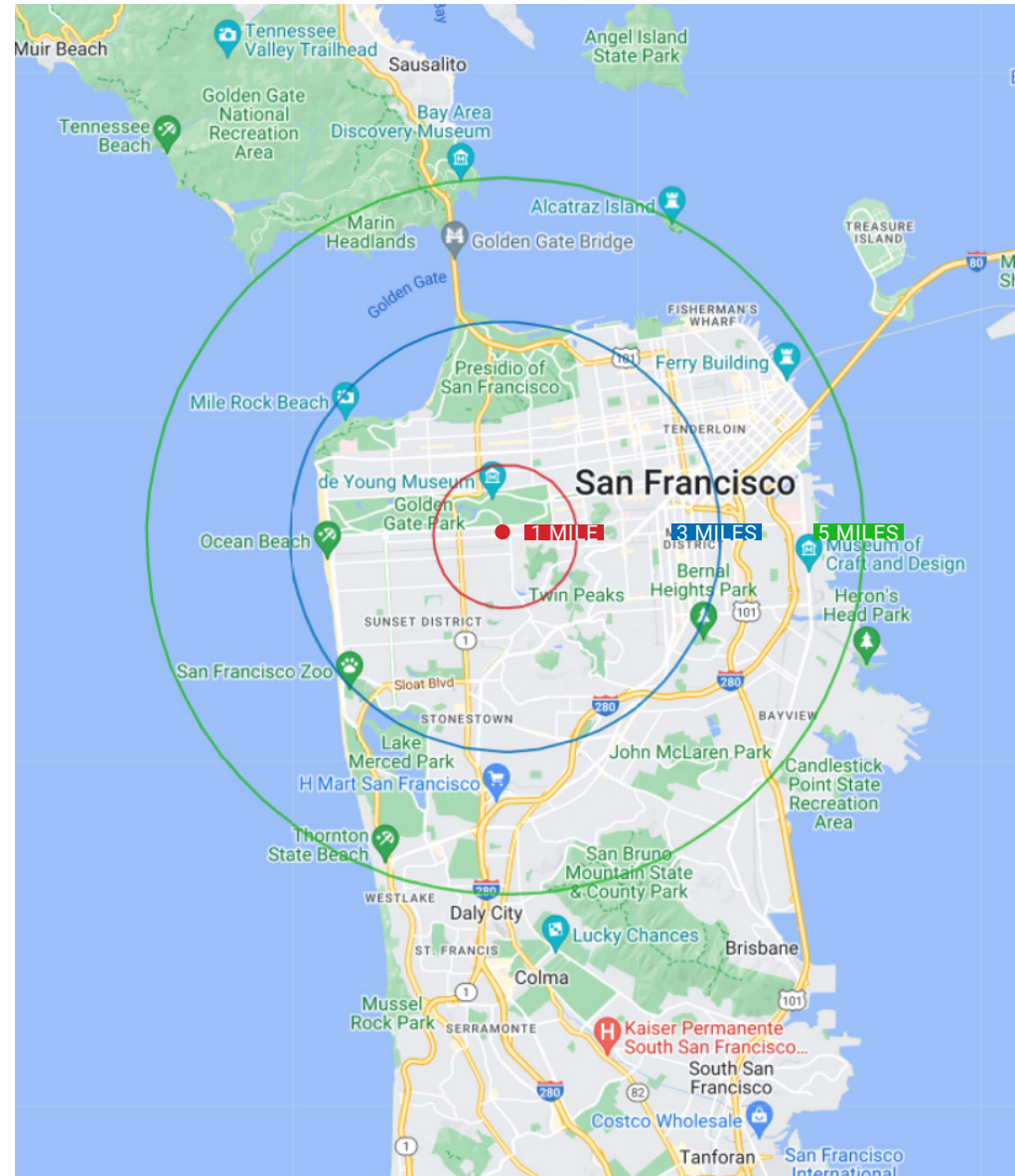

CELEBRATING
100 Years

JEREMY BLATTEIS
415.321.7493
jfblatteis@blatteisrealty.com
DRE #01460566

JONATHAN BLATTEIS
415.321.7486
jblatteis@blatteisrealty.com
DRE #00812015

ANDREW KRAFT
415.233.2142
akraft@blatteisrealty.com
DRE #02019054

SHARON KIM
415.310.2565
skim@blatteisrealty.com
DRE #01865334

sfretail.net

This Statement with the information it contains is given with the understanding that all negotiations relating to the purchase, renting or leasing of the property described above shall be conducted through Blatteis Realty Company. The above information, while not guaranteed, has been secured from sources believed to be reliable. Blatteis Realty has not verified its accuracy and make no guarantees, warranty or representation regarding this information and it is published subject to the possibility of errors, omissions, changes of listing information including price, term, financing, or withdrawal without notice. We include projections, estimates, opinions and/or assumptions, for example only, and they may not represent current or future performance of the property. You should consult your tax and legal advisors before to verify the validity of estimates. All commercial or mixed-use property presented by Blatteis Realty is subject to local zoning codes and regulations. It is the sole responsibility and liability of tenants and property owners to obtain all applicable required building permits and/or certificates from the local city/town Planning Department before commercial property use can commence or a building can be built.

101 Montgomery Suite 888, San Francisco, CA 94104 | t: 415.981.2844 | f: 415.981.4986 | info@brsfco | DRE #01421282

701 IRVING STREET SAN FRANCISCO, CA 94110

**BLATTEIS
REALTY CO**

®

INCORPORATED | EST. 1922

CELEBRATING
100 Years

JEREMY BLATTEIS

415.321.7493

jfblatteis@blatteisrealty.com

DRE #01460566

JONATHAN BLATTEIS

415.321.7486

jblatteis@blatteisrealty.com

DRE #00812015

ANDREW KRAFT

415.233.2142

akraft@blatteisrealty.com

DRE #02019054

SHARON KIM

415.310.2565

skim@blatteisrealty.com

DRE #01865334

This Statement with the information it contains is given with the understanding that all negotiations relating to the purchase, renting or leasing of the property described above shall be conducted through Blatteis Realty Company. The above information, while not guaranteed, has been secured from sources believed to be reliable. Blatteis Realty has not verified its accuracy and make no guarantees, warranty or representation regarding this information and it is published subject to the possibility of errors, omissions, changes of listing information including price, term, financing, or withdrawal without notice. We include projections, estimates, opinions and/or assumptions, for example only, and they may not represent current or future performance of the property. You should consult your tax and legal advisors before to verify the validity of estimates. All commercial or mixed-use property presented by Blatteis Realty is subject to local zoning codes and regulations. It is the sole responsibility and liability of tenants and property owners to obtain all applicable required building permits and/or certificates from the local city/town Planning Department before commercial property use can commence or a building can be built.

101 Montgomery Street, Suite 888, San Francisco, CA 94104 | www.sfretail.net | t: 415.981.2844 | f: 415.981.4986 | info@brsf.co | DRE #01421282