

FOR LEASE | RICHMOND DISTRICT

699 Spruce Street San Francisco



Please Call For Price

±1,400 SF

Great 2nd Floor Corner Office Available

Richmond District 2nd floor office space on Geary and Spruce now ready for lease!
Includes full floor with walk up.

CONTACT

David Blatteis 415-321-7488 | db@brsf.co | BRE#: 00418305

This statement with the information it contains, is given with the understanding that all negotiations relating to the purchase, renting or leasing of the property described above shall be conducted through this office. The above information, while not guaranteed, has been secured from sources believed to be reliable. We have not verified its accuracy and make no guarantee, warranty or representation regarding this information and it is published subject to the possibility of errors, omissions, changing of listing information including price, term, financing, or withdrawal without notice. We include projections, estimates, opinions, and/or assumptions, for example only, and they may not represent current or future performance of the property. You should consult your tax and legal advisors before to verify the validity of our estimates.



Map/Floorplan

699 Spruce Street

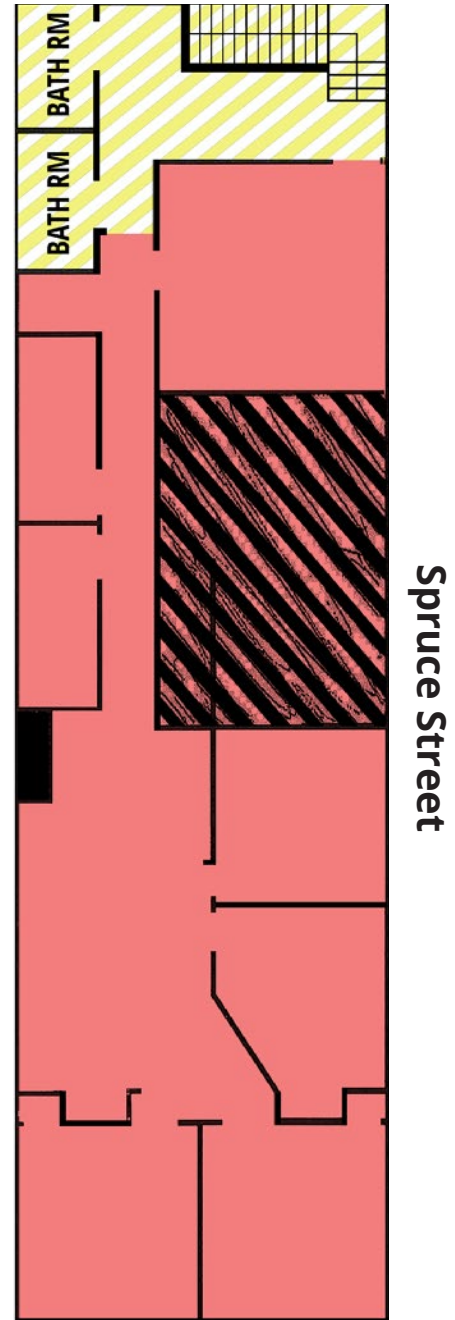
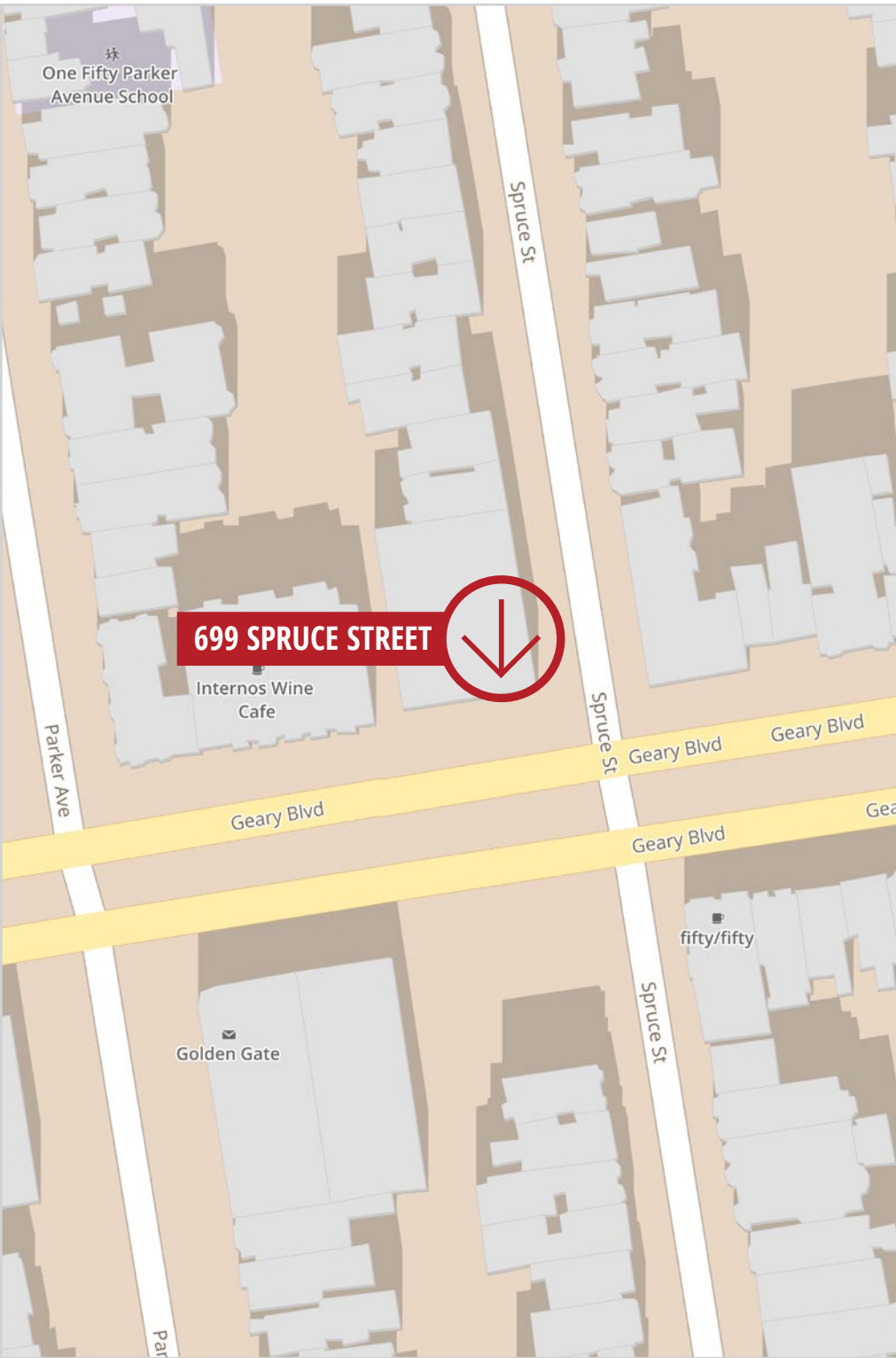

Geary Boulevard

- Rentable Space
- Common Area

CONTACT David Blatteis 415-321-7488 | db@brsf.co

This statement with the information it contains, is given with the understanding that all negotiations relating to the purchase, renting or leasing of the property described above shall be conducted through this office. The above information, while not guaranteed, has been secured from sources believed to be reliable. We have not verified its accuracy and make no guarantee, warranty or representation regarding this information and it is published subject to the possibility of errors, omissions, changing of listing information including price, term, financing, or withdrawal without notice. We include projections, estimates, opinions, and/or assumptions, for example only, and they may not represent current or future performance of the property. You should consult your tax and legal advisors before to verify the validity of our estimates.

Blatteis Realty Co - 44 Montgomery Street, Ste. 1288 | t: 415-981-2844 | f: 415-981-4986 | blatteisrealty@blatteisrealty.com | BRE#: 01421282