

FOR LEASE

# 2267 Market Street San Francisco



**Charming Retail/Office in Refreshing Upper Market**

**± 1,192 SF**

**Please Call for Price**

**CONTACT** **Ryan Abel** 415-321-7497 | ra@brsf.co | BRE#: 01465094  
**David Blatteis** 415-321-7488 | db@brsf.co | BRE#: 00418305

BLATTEIS REALTY CO. 44 Montgomery Street, Ste. 1288 | t: 415-981-2844 | f: 415-981-4986 | info@brsf.co | BRE#: 01421282 | www.sfretail.net

This statement with the information it contains, is given with the understanding that all negotiations relating to the purchase, renting or leasing of the property described above shall be conducted through this office. The above information, while not guaranteed, has been secured from sources believed to be reliable. We have not verified its accuracy and make no guarantee, warranty or representation regarding this information and it is published subject to the possibility of errors, omissions, changing of listing information including price, term, financing, or withdrawal without notice. We include projections, estimates, opinions, and/or assumptions, for example only, and they may not represent current or future performance of the property. You should consult your tax and legal advisors before to verify the validity of our estimates.



2267 MARKET STREET, SAN FRANCISCO CA

## INTERIOR PHOTOS



View of back deck

**CONTACT** **Ryan Abel**  
**David Blatteis**

415-321-7497 | [ra@brsf.co](mailto:ra@brsf.co) | BRE#: 01465094  
415-321-7488 | [db@brsf.co](mailto:db@brsf.co) | BRE#: 00418305

BLATTEIS REALTY CO. 44 Montgomery Street, Ste. 1288 | t: 415-981-2844 | f: 415-981-4986 | [info@brsf.co](mailto:info@brsf.co) | BRE#: 01421282 | [www.sfretail.net](http://www.sfretail.net)

This statement with the information it contains, is given with the understanding that all negotiations relating to the purchase, renting or leasing of the property described above shall be conducted through this office. The above information, while not guaranteed, has been secured from sources believed to be reliable. We have not verified its accuracy and make no guarantee, warranty or representation regarding this information and it is published subject to the possibility of errors, omissions, changing of listing information including price, term, financing, or withdrawal without notice. We include projections, estimates, opinions, and/or assumptions, for example only, and they may not represent current or future performance of the property. You should consult your tax and legal advisors before to verify the validity of our estimates.



# 2267 MARKET STREET, SAN FRANCISCO CA

## ABOUT

Resting just on the edge of The Castro, Duboce Triangle, and Upper Market districts, 2267 Market Street offers a unique opportunity for emerging or established retailers to tap into this area's growth and economic health in a well maintained multi-tenant commercial building. Tenant's nearby include: Peet's Coffee, CVS Pharmacy, Fitness SF, Walgreens, Starbelly, Illy Cafe, Bank of America, and many more.

## MAP

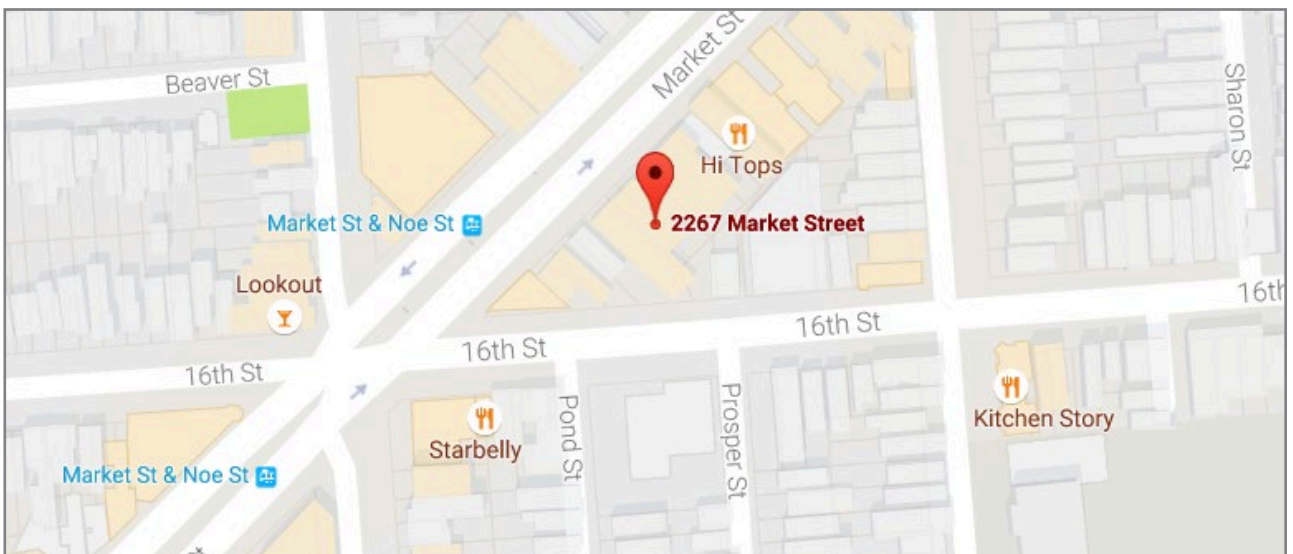

## FLOORPLAN

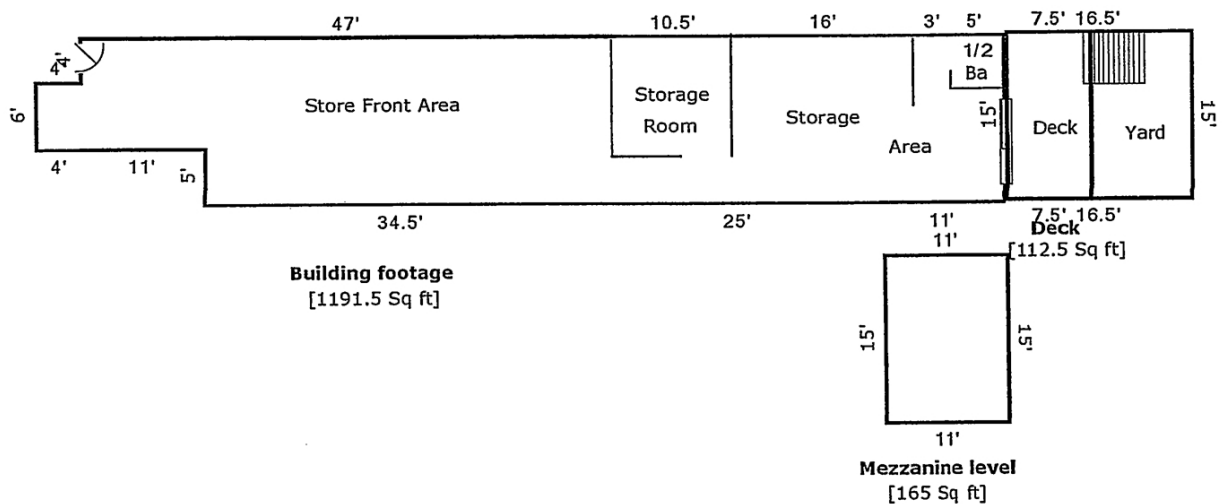

**CONTACT** Ryan Abel  
David Blatteis

415-321-7497 | ra@brsf.co | BRE#: 01465094  
415-321-7488 | db@brsf.co | BRE#: 00418305

BLATTEIS REALTY CO. 44 Montgomery Street, Ste. 1288 | t: 415-981-2844 | f: 415-981-4986 | info@brsf.co | BRE#: 01421282 | www.sfretail.net

This statement with the information it contains, is given with the understanding that all negotiations relating to the purchase, renting or leasing of the property described above shall be conducted through this office. The above information, while not guaranteed, has been secured from sources believed to be reliable. We have not verified its accuracy and make no guarantee, warranty or representation regarding this information and it is published subject to the possibility of errors, omissions, changing of listing information including price, term, financing, or withdrawal without notice. We include projections, estimates, opinions, and/or assumptions, for example only, and they may not represent current or future performance of the property. You should consult your tax and legal advisors before to verify the validity of our estimates.

